

**THIS IS A DRAFT COPY ONLY AND IS NOT AN OFFICIAL COPY OF THE
FINAL, ADOPTED ORDINANCE.**

RESOLUTION

A RESOLUTION ABANDONING A PUBLIC UTILITY EASEMENT
LOCATED ON THE PARCELS WITH APNS 214-15-011G AND
214-15-120A AND LOCATED NEAR THE SOUTHEAST CORNER
OF BELL ROAD AND 14TH STREET, PURSUANT TO
APPLICATION 200509.

BE IT RESOLVED BY THE COUNCIL OF THE CITY OF PHOENIX as
follows:

SECTION 1. That pursuant to Section 31-64 of the Phoenix City Code, a
public utility easement located on the parcels with APNs 214-15-011G and 214-15-120A
and located near the southeast corner of Bell Road and 14th Street, as described in
Exhibit A and shown in Exhibit B, which are attached hereto and by this reference made
part hereof, which is no longer needed for public use, is abandoned with title thereto to
vest according to law.

PASSED by the Council of the City of Phoenix this 21st day of October,
2020.

MAYOR

ATTEST:

Denise Archibald, City Clerk

APPROVED AS TO FORM:
Cris Meyer, City Attorney

By: _____
Julie Kriegh, Chief Assistant City Attorney *Pml*

REVIEWED BY:

Ed Zuercher, City Manager

PL:tml:LF20-2495:10-21-2020:2215249v1

DRAFT

EXHIBIT "A"



PAGE 1 OF 1

September 23, 2020
PROJECT # 050750-01-001

LEGAL DESCRIPTION PUBLIC UTILITY EASEMENT ABANDONMENT

THAT PORTION OF THE NORTHEAST QUARTER OF SECTION 4, TOWNSHIP 3 NORTH, RANGE 3 EAST OF THE GILA AND SALT RIVER BASE AND MERIDIAN, MARICOPA COUNTY, ARIZONA, DESCRIBED AS FOLLOWS:

COMMENCING AT THE NORTHEAST CORNER OF SAID SECTION 4, BEING MARKED BY A CITY OF PHOENIX BRASS CAP IN HANDHOLE, FROM WHICH POINT THE EAST QUARTER CORNER OF SAID SECTION 4, BEARS SOUTH 00°00'00" WEST, A DISTANCE OF 2641.57 FEET;

THENCE SOUTH 00°00'00" WEST, ALONG THE EAST LINE OF SAID NORTHEAST QUARTER, A DISTANCE OF 341.86 FEET;

THENCE DEPARTING SAID EAST LINE, NORTH 90°00'00" WEST, A DISTANCE OF 664.94 FEET TO **POINT OF BEGINNING #1**;

THENCE SOUTH 00°00'58" WEST, A DISTANCE OF 326.71 FEET TO A POINT HEREIN REFERRED TO AS POINT "A";

THENCE SOUTH 89°59'18" EAST, A DISTANCE OF 8.00 FEET;

THENCE NORTH 00°00'58" EAST, A DISTANCE OF 318.71 FEET;

THENCE SOUTH 89°59'18" WEST, A DISTANCE OF 148.32 FEET;

THENCE NORTH 00°00'58" EAST, A DISTANCE OF 8.00 FEET;

THENCE NORTH 89°59'18" EAST, A DISTANCE OF 156.32 FEET TO **POINT OF BEGINNING #1**;

AND ALSO;

COMMENCING AT SAID POINT "A"

THENCE SOUTH 00°00'58" WEST, A DISTANCE OF 25.00 FEET TO **POINT OF BEGINNING #2**;

THENCE SOUTH 00°00'58" WEST, A DISTANCE OF 603.46 FEET;

THENCE NORTH 89°59'13" WEST, A DISTANCE OF 8.00 FEET;

THENCE NORTH 00°00'58" EAST, A DISTANCE OF 293.73 FEET;

THENCE SOUTH 89°59'23" WEST, A DISTANCE OF 148.32 FEET;

THENCE NORTH 00°00'37" WEST, A DISTANCE OF 16.00 FEET;

THENCE NORTH 89°59'23" EAST, A DISTANCE OF 148.32 FEET;

THENCE NORTH 00°00'58" EAST, A DISTANCE OF 293.75 FEET;

THENCE NORTH 89°59'23" EAST, A DISTANCE OF 8.00 FEET TO **POINT OF BEGINNING #2**.

CONTAINING 11,001 SQ.FT. OR 0.2525 ACRES, MORE OR LESS.

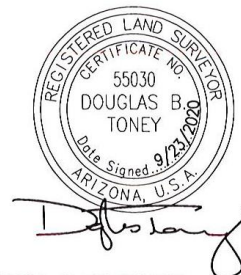
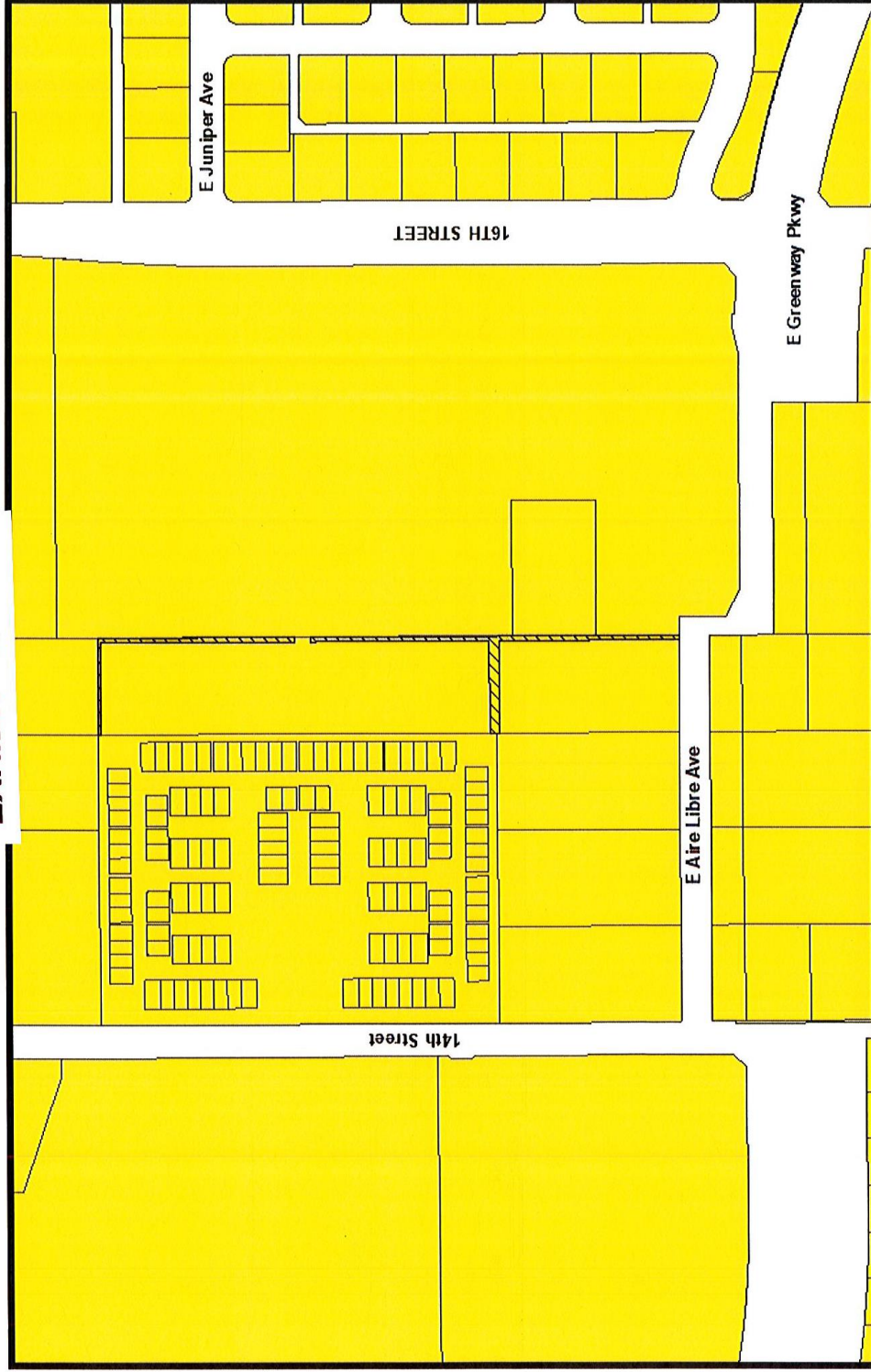
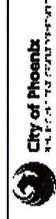



EXHIBIT "B"



0 150 300 Feet



QUARTER SECTION: 36-30
DATE : 02/27/2020
DOCKET and PAGE: 055 & 27

APPLICANT: Bowman Consulting; David Maldonado
ABANDONMENT AREA: 
APPLICATION NO: ABND 200509