

ATTACHMENT A

**THIS IS A DRAFT COPY ONLY AND IS NOT AN OFFICIAL COPY OF THE FINAL,
ADOPTED ORDINANCE**

ORDINANCE G-

AN ORDINANCE AMENDING THE ZONING DISTRICT MAP ADOPTED PURSUANT TO SECTION 601 OF THE CITY OF PHOENIX ZONING ORDINANCE BY CHANGING THE ZONING DISTRICT CLASSIFICATION FOR THE PARCEL DESCRIBED HEREIN (CASE Z-SP-9-22-7) FROM C-2 (INTERMEDIATE COMMERCIAL) TO C-2 SP (INTERMEDIATE COMMERCIAL, SPECIAL PERMIT).

BE IT ORDAINED BY THE COUNCIL OF THE CITY OF PHOENIX, as follows:

SECTION 1. The zoning of a 5.43-acre property located at the southwest corner of 35th Avenue and Broadway Road in a portion of Section 27, Township 1 North, Range 2 East, as described more specifically in Exhibit "A," is hereby changed from "C-2" (Intermediate Commercial), to "C-2 SP" (Intermediate Commercial, Special Permit) to allow self-service storage and all underlying C-2 uses.

SECTION 2. The Planning and Development Director is instructed to modify the Zoning Map of the City of Phoenix to reflect this use district classification change as shown in Exhibit "B."

SECTION 3. Due to the site's specific physical conditions and the use district applied for by the applicant, this rezoning is subject to the following stipulations,

violation of which shall be treated in the same manner as a violation of the City of Phoenix Zoning Ordinance:

1. The development shall be in general conformance with the site plan date stamped November 29, 2022, as modified by the following stipulations and approved by the Planning and Development Department.
2. The development shall be in general conformance with the elevations date stamped October 26, 2022, as modified by the following stipulations and approved by the Planning and Development Department.
3. A minimum 25-foot-wide landscape setback shall be provided along the western portion of the site and planted with minimum 2-inch caliper, evergreen trees, planted 20-feet on-center or in equivalent groupings, providing a solid minimum 30-foot vertical screen at maturity, as approved by the Planning and Development Department.
4. A minimum 6-foot-tall wrought-iron fence, solid wall or combination thereof, shall be provided along the western property line between the existing alley and Building B, as depicted in the site plan date stamped November 29, 2022, as approved by the Planning and Development Department.
5. All uncovered surface parking lot areas for employees and customers shall be landscaped with minimum 2-inch caliper large canopy, drought-tolerant shade trees. Landscaping shall be dispersed throughout the parking area and achieve 25% shade at maturity, as approved by Planning and Development Department.
6. Where pedestrian pathways cross drive aisles, the pathway shall be constructed of decorative pavers, stamped or colored concrete, or other pavement treatments that visually contrast with the adjacent parking and drive aisle surfaces, as approved by the Planning and Development Department.
7. A minimum of two bicycle parking spaces shall be provided through Inverted U and/or artistic racks located near building entrances and installed per the requirements of Section 1307.H. of the Phoenix Zoning Ordinance, as approved by the Planning and Development Department.
8. The landscape strips located between the detached sidewalk and back of curb along 35th Avenue and Broadway Road shall be planted to the following standards, as approved by the Planning and Development Department.
 - a. Minimum 2-inch caliper single-trunk, large canopy, drought-tolerant shade trees planted minimum 20 feet on center or in equivalent groupings, providing a minimum of 75% shade at maturity.

- b. Minimum 5-gallon shrubs providing 75% live cover at maturity.

Where utility conflicts exist, the developer shall work with the Planning and Development Department on alternative design solutions consistent with a pedestrian environment.

- 9. The developer shall replace the existing rolled curb with vertical curb along Tamarisk Avenue, as approved by the Planning and Development Department.
- 10. The developer shall dedicate 10 feet for the east side of the alley, as approved by the Planning and Development Department.
- 11. The developer shall construct all streets within and adjacent to the development with paving, curb, gutter, sidewalk, curb ramps, streetlights, median islands, landscaping and other incidentals, as per plans approved by the Planning and Development Department. All improvements shall comply with all ADA accessibility standards.
- 12. If determined necessary by the Phoenix Archeology Office, the applicant shall conduct Phase I data testing and submit an archaeological survey report of the development area for review and approval by the City Archeologist prior to clearing and grubbing, landscape salvage, and/or grading approval.
- 13. If Phase I data testing is required, and if, upon review of the results from Phase I data testing, the City Archeologist, in consultation with a qualified archeologist, determines such data recovery excavations are necessary, the applicant shall conduct Phase II archeological data recovery excavations.
- 14. In the event archeological materials are encountered during construction, the developer shall immediately cease all ground-disturbing activities within a 33-foot radius of the discovery, notify the City Archeologist, and allow time for the Archeology Office to properly assess the materials.
- 15. Prior to preliminary site plan approval, the landowner shall execute a Proposition 207 waiver of claims form. The waiver shall be recorded with the Maricopa County Recorder's Office and delivered to the City to be included in the rezoning application file for record.
- 16. No monument or ground signs shall be permitted on the site.
- 17. No illuminated signs are allowed on Building B, as depicted on the site plan date stamped November 29, 2022.

SECTION 4. If any section, subsection, sentence, clause, phrase or portion of this ordinance is for any reason held to be invalid or unconstitutional by the decision of any court of competent jurisdiction, such decision shall not affect the validity of the remaining portions hereof.

PASSED by the Council of the City of Phoenix this 1st day of February, 2023.

MAYOR

ATTEST:

Denise Archibald, City Clerk

APPROVED AS TO FORM:
Julie M. Kriegh, City Attorney

By:

REVIEWED BY:

Jeffrey Barton, City Manager

Exhibits:

A – Legal Description (1 Page)

B – Ordinance Location Map (1 Page)

EXHIBIT A

THE EAST HALF OF THE EAST HALF OF LOT 11, MARICOPA GARDEN FARMS,
ACCORDING TO BOOK 11 OF MAPS, PAGE 38, OFFICIAL RECORDS OF
MARICOPA COUNTY, ARIZONA, LESS AND EXCEPT THE SOUTH 25 FEET
THEREOF.

DRAFT

ORDINANCE LOCATION MAP

EXHIBIT B

ZONING SUBJECT TO STIPULATIONS: *

SUBJECT AREA: ■ ■ ■ ■ ■

Zoning Case Number: Z-SP-9-22-7

Zoning Overlay: N/A

Planning Village: Laveen

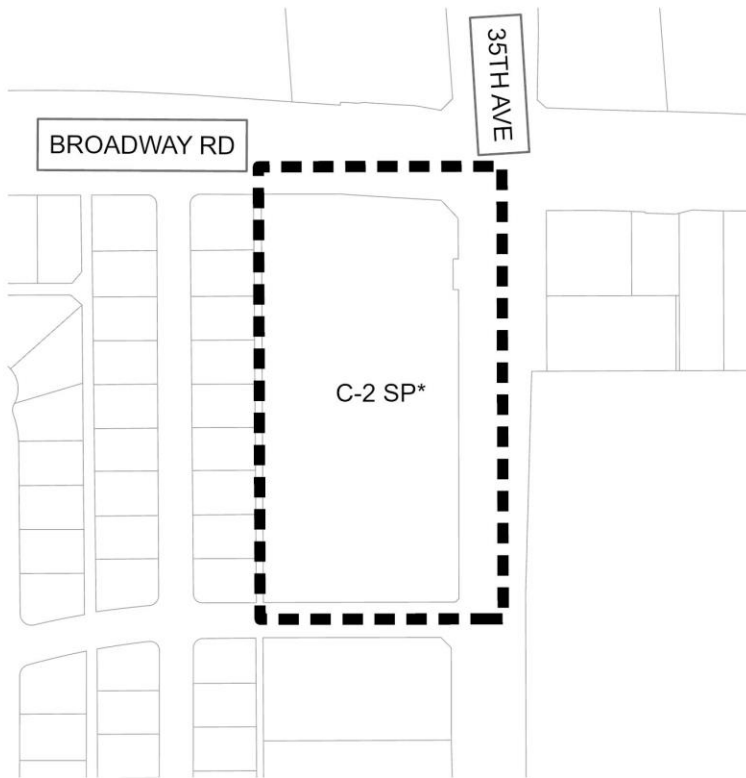

0 112.5 225 450 Feet

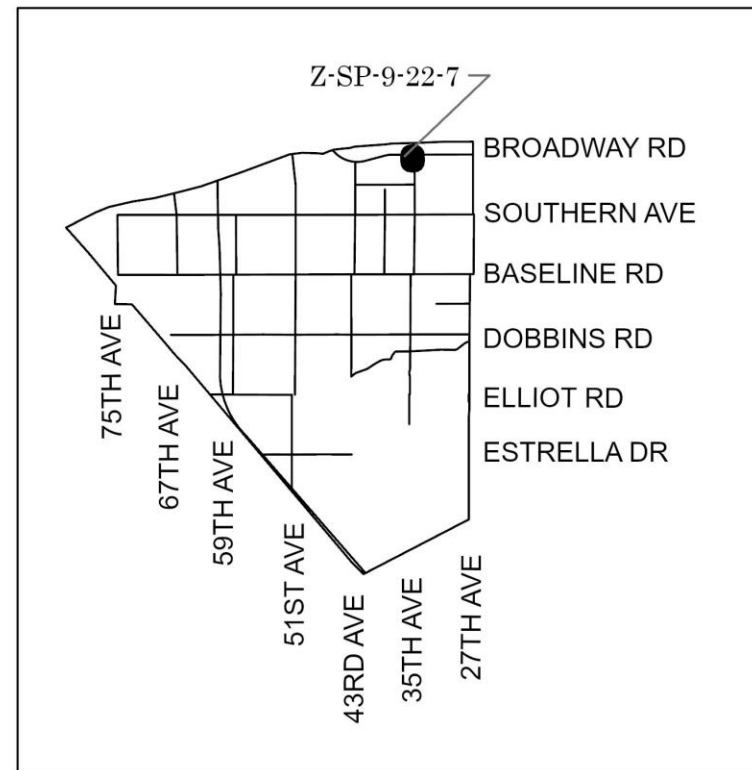

NOT TO SCALE



Drawn Date: 1/6/2023