

ATTACHMENT A

**THIS IS A DRAFT COPY ONLY AND IS NOT AN OFFICIAL COPY OF THE FINAL,
ADOPTED ORDINANCE**

ORDINANCE G-

AN ORDINANCE AMENDING THE ZONING DISTRICT MAP ADOPTED PURSUANT TO SECTION 601 OF THE CITY OF PHOENIX ZONING ORDINANCE BY CHANGING THE ZONING DISTRICT CLASSIFICATION FOR THE PARCEL DESCRIBED HEREIN (Z-39-22-5) FROM R-5 SP (MULTIFAMILY RESIDENCE DISTRICT, SPECIAL PERMIT) to R-5 (MULTIFAMILY RESIDENCE DISTRICT).

BE IT ORDAINED BY THE COUNCIL OF THE CITY OF PHOENIX, as follows:

SECTION 1. The zoning of a 0.65 acre property located approximately 340 feet east of the southeast corner of 29th Avenue and Northern Avenue, in a portion of Section 2, Township 2 North, and Range 2 East, as described more specifically in Exhibit "A", is hereby changed from "R-5 SP" (Multifamily Residence District, Special Permit) to "R-5" (Multifamily Residence District).

SECTION 2. The Planning and Development Director is instructed to modify the Zoning Map of the City of Phoenix to reflect this use district classification change as shown in Exhibit "B".

SECTION 3. If any section, subsection, sentence, clause, phrase or portion of this ordinance is for any reason held to be invalid or unconstitutional by the

decision of any court of competent jurisdiction, such decision shall not affect the validity of the remaining portions hereof.

PASSED by the Council of the City of Phoenix this 12th day of October, 2022.

MAYOR

ATTEST:

Denise Archibald, City Clerk

APPROVED AS TO FORM:
Cris Meyer, City Attorney

By:

REVIEWED BY:

Jeffrey Barton, City Manager

Exhibits:
A – Legal Description (1 Page)
B – Ordinance Location Map (1 Page)

EXHIBIT A

THE LAND REFERRED TO HEREIN BELOW IS SITUATED IN PHOENIX, IN A PORTION OF SECTION 2, TOWNSHIP 2 NORTH, RANGE 2 EAST, IN THE COUNTY OF MARICOPA, STATE OF ARIZONA, AND IS DESCRIBED AS FOLLOWS:

Parcel No. 1:

Lot 6, BEVERLY ACRES, according to Book 15 of Maps, Page 34, records of Maricopa County, Arizona;

EXCEPT the east 75.00 feet thereof; and

EXCEPT the North 7.00 feet.

Parcel No. 2:

The East 75.00 feet of Lot 6, BEVERLY ACRES, according to Book 15 of Maps, page 34, records of Maricopa County, Arizona;

EXCEPT the North 157.00 feet thereof.

Parcel No. 3;

The North 157.00 feet of the East 75.00 feet of Lot 6, BEVERLY ACRES, according to Book 15 of Maps, Page 34, records of Maricopa County, Arizona;

EXCEPT the North 7.00 feet.

ORDINANCE LOCATION MAP

EXHIBIT B

ZONING SUBJECT TO STIPULATIONS: *
SUBJECT AREA: ■ ■ ■ ■ ■

Zoning Case Number: Z-39-22-5
Zoning Overlay: N/A
Planning Village: Alhambra

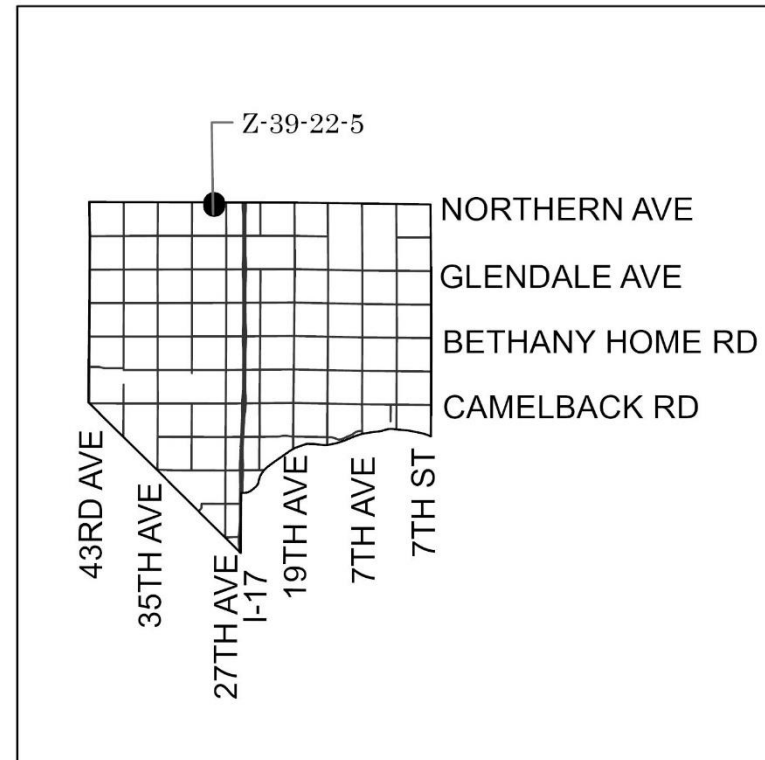
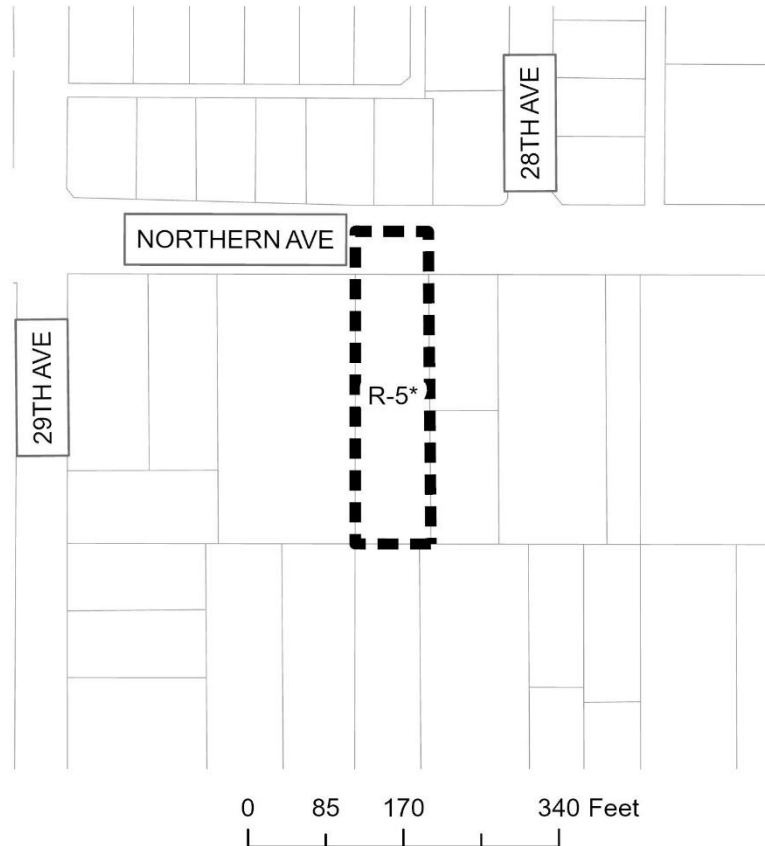

NOT TO SCALE



Drawn Date: 9/13/2022