

# Attachment A

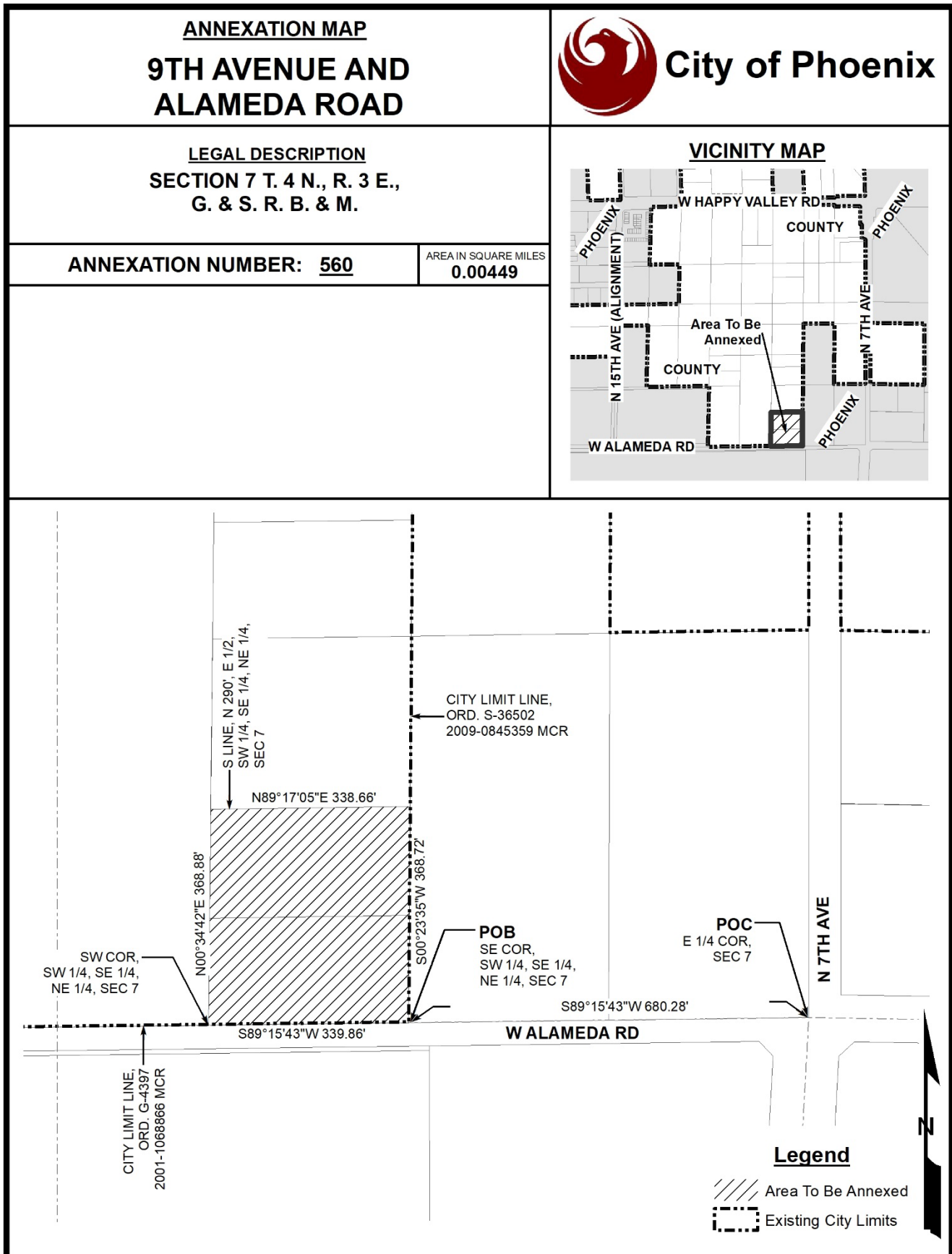

# **EXHIBIT "A"**

## **DESCRIPTION OF ANNEXATION**

A PORTION OF THE EAST HALF OF THE SOUTHWEST QUARTER OF THE SOUTHEAST QUARTER OF THE NORTHEAST QUARTER OF SECTION 7, TOWNSHIP 4 NORTH, RANGE 3 EAST OF THE GILA AND SALT RIVER BASE AND MERIDIAN, MARICOPA COUNTY, ARIZONA, BEING MORE PARTICULARLY DESCRIBED AS FOLLOWS:

COMMENCING AT 3-INCH MARICOPA COUNTY BRASS CAP IN HANDHOLE STAMPED "33307 2003" MARKING THE EAST QUARTER CORNER OF SECTION 7 FROM WHICH AN IRON ROD WITH NO IDENTIFICATION (1.00' EAST) MARKING THE CENTER OF SAID SECTION 7 BEARS SOUTH 89 DEGREES 15 MINUTES 43 SECONDS WEST 2722.16 FEET, SAID DESCRIBED LINE BEING THE BASIS OF BEARINGS FOR THIS DESCRIPTION;

THENCE SOUTH 89 DEGREES 15 MINUTES 43 SECONDS WEST 680.28 FEET ALONG THE SOUTH LINE OF THE NORTHEAST QUARTER OF SAID SECTION 7 TO A HALF-INCH REBAR WITH RED PLASTIC CAP STAMPED "LS 79657" MARKING THE SOUTHEAST CORNER OF THE SOUTHWEST QUARTER OF THE SOUTHEAST QUARTER OF THE NORTHEAST QUARTER OF SAID SECTION 7 AND THE POINT OF BEGINNING;

THENCE CONTINUING SOUTH 89 DEGREES 15 MINUTES 43 SECONDS WEST 339.86 FEET ALONG SAID SOUTH LINE TO A NAIL IN WASHER STAMPED "KLEIN 42137" MARKING THE SOUTHWEST CORNER OF THE EAST HALF OF THE SOUTHWEST QUARTER OF THE SOUTHEAST QUARTER OF THE NORTHEAST QUARTER OF SAID SECTION 7;

THENCE NORTH 00 DEGREES 34 MINUTES 42 SECONDS EAST 368.88 FEET ALONG THE WEST LINE OF SAID EAST HALF TO A HALF-INCH REBAR WITH ALUMINUM CAP STAMPED "KLEIN 42137" MARKING A POINT ON THE SOUTH LINE OF THE NORTH 290.00 FEET OF SAID EAST HALF;

THENCE NORTH 89 DEGREES 17 MINUTES 05 SECONDS EAST 338.66 FEET ALONG SAID SOUTH LINE TO A HALF-INCH REBAR WITH RED PLASTIC CAP STAMPED "LS 79657" MARKING A POINT ON THE EAST LINE OF THE SOUTHWEST QUARTER OF THE SOUTHEAST QUARTER OF THE NORTHEAST QUARTER OF SAID SECTION 7;

THENCE SOUTH 00 DEGREES 23 MINUTES 35 SECONDS WEST 368.72 FEET ALONG SAID EAST LINE TO THE POINT OF BEGINNING.

COMPRISING 125,091 SQUARE FEET MORE OR LESS.



  
**SUPERIOR**  
SURVEYING SERVICES, INC.

2122 W. Lone Cactus Dr.  
Ste. 11, Phoenix, AZ 85027  
623-869-0223 (office)  
623-869-0726 (fax)  
www.superiorsurveying.com  
info@superiorsurveying.com

DATE: 7/21/2025

JOB NO.: 202506083-EX

# EXHIBIT "B"

DEPICTION OF  
ANNEXATION

LINE TABLE		
LINE	BEARING	DISTANCE
L1	N 00°34'42" E	368.88'
L2	N 89°17'05" E	338.66'
L3	S 00°23'35" W	368.72'

A.P.N.  
210-08-008C

SOUTHWEST CORNER,  
E. 1/2, SW. 1/4,  
SE. 1/4, NE. 1/4,  
SECTION 7

1702.02'

S 89°15'43" W

CENTER OF SECTION 7, T-4N, R-3E  
FOUND IRON ROD WITH NO  
IDENTIFICATION (1.00' EAST)

19TH AVENUE

NOT TO SCALE

A.P.N.  
210-08-022C

A.P.N. 210-08-025C

SOUTHEAST CORNER,  
SW. 1/4, SE. 1/4,  
NE. 1/4, SECTION 7

339.86'

ALAMEDA ROAD

(BASIS OF BEARING)

POINT OF  
BEGINNING

2722.16'

680.28'

EAST 1/4 CORNER  
SECTION 7, T-4N, R-3E  
FOUND 3" MARICOPA COUNTY  
BRASS CAP IN HANDHOLE  
STAMPED "33307 2003"  
POINT OF COMMENCEMENT

7TH AVENUE



*David S. Klein*



**SUPERIOR**  
SURVEYING SERVICES, INC.

2122 W. Lone Cactus Dr., Ste. 11  
Phoenix, AZ 85027  
623-869-0223 (office)  
623-869-0726 (fax)  
www.superiorsurveying.com  
info@superiorsurveying.com

DATE: 7/21/2025

JOB NO.: 202506083-EX