

**ATTACHMENT A**

**THIS IS A DRAFT COPY ONLY AND IS NOT AN OFFICIAL COPY OF THE FINAL,  
ADOPTED ORDINANCE**

ORDINANCE G-

AN ORDINANCE AMENDING SECTION 601 OF THE CITY OF PHOENIX ZONING ORDINANCE BY ADOPTING OFFICIAL SUPPLEMENTARY ZONING MAP 1258.

\_\_\_\_\_

BE IT RESOLVED BY THE COUNCIL OF THE CITY OF PHOENIX as

follows:

SECTION 1. That Section 601 of the City of Phoenix Zoning Ordinance is hereby amended by adopting Official Supplementary Zoning Map 1258, which accompanies and is annexed to this ordinance and declared a part hereof.

PASSED by the Council of the City of Phoenix this 15th day of November, 2023.

\_\_\_\_\_  
MAYOR

ATTEST:

\_\_\_\_\_  
Denise Archibald, City Clerk

APPROVED AS TO FORM:  
Julie M. Kriegh, City Attorney

By: \_\_\_\_\_  
\_\_\_\_\_

REVIEWED BY:

\_\_\_\_\_  
Jeffrey Barton, City Manager

PL:arm:LF23-2664:11-15-2023

DRAFT

# OFFICIAL SUPPLEMENTARY ZONING MAP NO. 1258

Sheet 1 of 1

ORDINANCE NO. \_\_\_\_\_ AMENDING SECTION 601 OF THE CITY OF PHOENIX ZONING ORDINANCE

Passed by the Council of the City of Phoenix, Arizona this 15th day of November 2023.

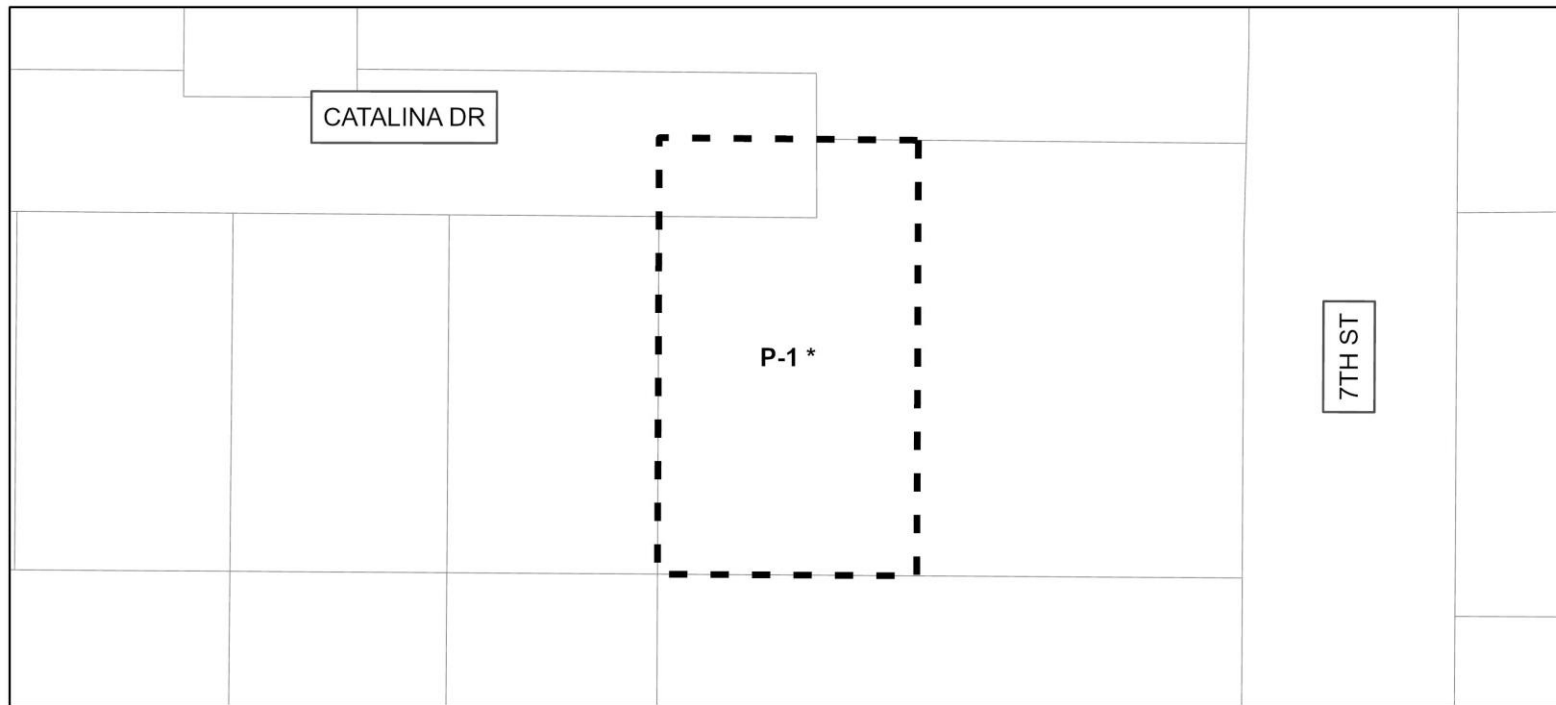

Z-239-61

Drawn by: KS

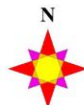

ZONING SUBJECT TO STIPULATIONS: \*

AREA INVOLVED BOUNDED THUS: - - - - -