

ATTACHMENT A

**THIS IS A DRAFT COPY ONLY AND IS NOT AN OFFICIAL COPY OF THE FINAL,
ADOPTED ORDINANCE**

ORDINANCE G-

AN ORDINANCE AMENDING THE ZONING DISTRICT MAP ADOPTED PURSUANT TO SECTION 601 OF THE CITY OF PHOENIX ZONING ORDINANCE BY CHANGING THE ZONING DISTRICT CLASSIFICATION FOR THE PARCEL DESCRIBED HEREIN (Z-32-23-3) FROM R1-10 (SINGLE-FAMILY RESIDENCE DISTRICT) TO C-3 (GENERAL COMMERCIAL).

BE IT ORDAINED BY THE COUNCIL OF THE CITY OF PHOENIX, as follows:

SECTION 1. The zoning of a 1.20-acre property located approximately 360 feet east of the southeast corner of Cave Creek Road and Mescal Street in a portion of Section 22, Township 3 North, Range 3 East, as described more specifically in Exhibit "A," is hereby changed from "R1-10" (Single-Family Residence District) to "C-3" (General Commercial).

SECTION 2. The Planning and Development Director is instructed to modify the Zoning Map of the City of Phoenix to reflect this use district classification change as shown in Exhibit "B."

SECTION 3. Due to the site's specific physical conditions and the use district applied for by the applicant, this rezoning is subject to the following stipulations, violation of which shall be treated in the same manner as a violation of the City of Phoenix Zoning Ordinance:

1. No bay or loading doors shall be located on perimeter building elevations facing the R-3 residential district.
2. The maximum building height shall be 15 feet.
3. Where pedestrian walkways cross a vehicular path, the pathway shall be constructed of decorative pavers, stamped or colored concrete, or other pavement treatments that visually contrasts parking and drive aisle surfaces, as approved by the Planning and Development Department.
4. All uncovered surface parking lot areas shall be landscaped with minimum 2-inch caliper drought-tolerant shade trees. Landscaping shall be dispersed throughout the parking area and achieve 25 percent shade at maturity, as approved by Planning and Development Department.
5. A minimum of two bicycle parking spaces shall be provided through Inverted U and/or artistic racks located near building entrances and installed per the requirements of Section 1307.H. of the Phoenix Zoning Ordinance, as approved by the Planning and Development Department. A minimum of one of the required bicycle parking spaces shall include standard electrical receptacles for electric bicycle charging capabilities, as approved by the Planning and Development Department.
6. A minimum of one parking space shall be EV Ready.
7. In the event archaeological materials are encountered during construction, the developer shall immediately cease all ground-disturbing activities within a 33-foot radius of the discovery, notify the City Archaeologist, and allow time for the Archaeology Office to properly assess the materials.
8. Prior to preliminary site plan approval, the landowner shall execute a Proposition 207 waiver of claims form. The waiver shall be recorded with the Maricopa County Recorder's Office and delivered to the City to be included in the rezoning application file for record.

SECTION 4. If any section, subsection, sentence, clause, phrase or portion of this ordinance is for any reason held to be invalid or unconstitutional by the decision of any court of competent jurisdiction, such decision shall not affect the validity of the remaining portions hereof.

PASSED by the Council of the City of Phoenix this 3rd day of January
2024.

MAYOR

ATTEST:

Denise Archibald, City Clerk

APPROVED AS TO FORM:
Julie M. Kriegh, City Attorney

By:

REVIEWED BY:

Jeffrey Barton, City Manager

Exhibits:
A – Legal Description (1 Page)
B – Ordinance Location Map (1 Page)

EXHIBIT A

LEGAL DESCRIPTION FOR Z-32-23-3

That part of the Santa Rosa Mining Claim, within the Southwest quarter of Section 22, Township 3 North, Range 3 East of the Gila and Salt River Base and Meridian, Maricopa County, Arizona, being a portion of Mineral Survey No. 4112, according to the Patent recorded in Book 285 of Deeds, Page 579 thereof, and described as follows:

BEGINNING at the Southwest corner of the Northwest quarter of the Southwest quarter of said Section 22;

thence South along the West line of said Section 90 feet;

thence East 215 feet:

thence North parallel to the West line of said Section 240 feet:

thence West 215 feet, to the West line of said Section;

thence South along said West line 150 feet to the POINT OF BEGINNING.

ORDINANCE LOCATION MAP

EXHIBIT B

ZONING SUBJECT TO STIPULATIONS: *

SUBJECT AREA: ■ ■ ■ ■ ■

Zoning Case Number: Z-32-23-3

Zoning Overlay: N/A

Planning Village: North Mountain

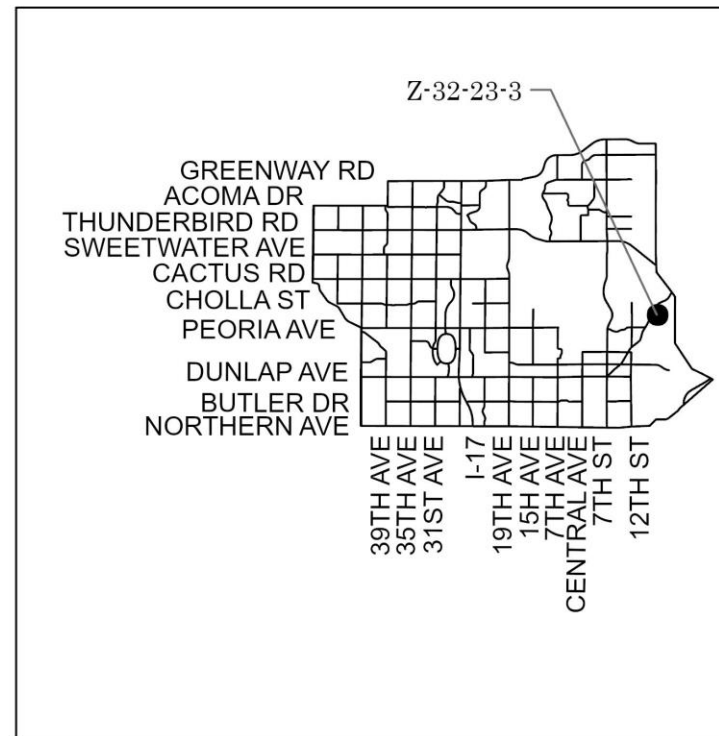
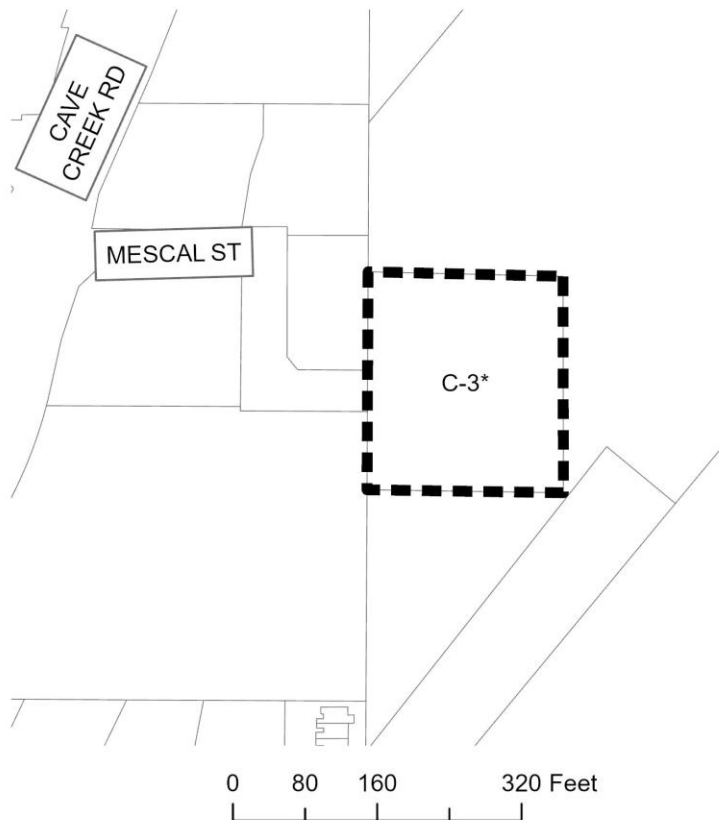

NOT TO SCALE



Drawn Date: 9/25/2023