

ATTACHMENT A

**THIS IS A DRAFT COPY ONLY AND IS NOT AN OFFICIAL COPY OF THE FINAL,
ADOPTED RESOLUTION**

RESOLUTION _____

A RESOLUTION ADOPTING AN AMENDMENT TO THE
2015 GENERAL PLAN FOR PHOENIX, APPLICATION
GPA-SM-3-17-8, CHANGING THE LAND USE
CLASSIFICATION FOR THE PARCEL DESCRIBED
HEREIN.

BE IT RESOLVED BY THE COUNCIL OF THE CITY OF PHOENIX, as

follows:

SECTION 1. The 2015 Phoenix General Plan which was adopted by Resolution No. 21307, is hereby amended by adopting GPA-SM-3-17-8, 11.15 acres located approximately 130 feet north of the northwest corner of 19th Avenue and Latona Lane for 11.15 acres of Residential 2 to 3.5 dwelling units per acre as approved by the City Council on January 10, 2018 and that the Planning and Development Director is instructed to modify The 2015 Phoenix General Plan to reflect this land use classification change as shown below:

PROPOSED CHANGE:

Residential 2 to 3.5 DU/Acre (11.15 +/- Acres)

 Residential 2 to 3.5 du/acre

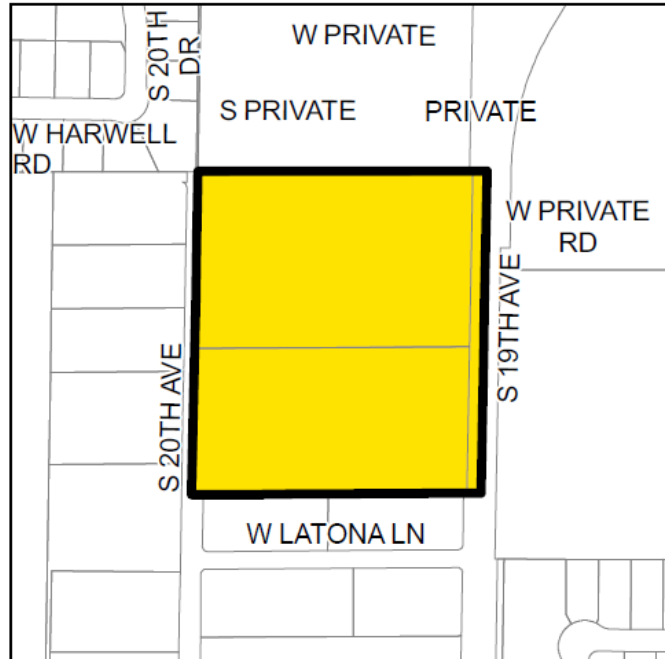

PASSED by the Council of the City of Phoenix this 10th day of January 10, 2018.

MAYOR

ATTEST:

City Clerk

APPROVED AS TO FORM:

City Attorney

REVIEWED BY:

City Manager

PL:tml:____v1 (CM __) (Item __) 01/10/18