

Attachment B

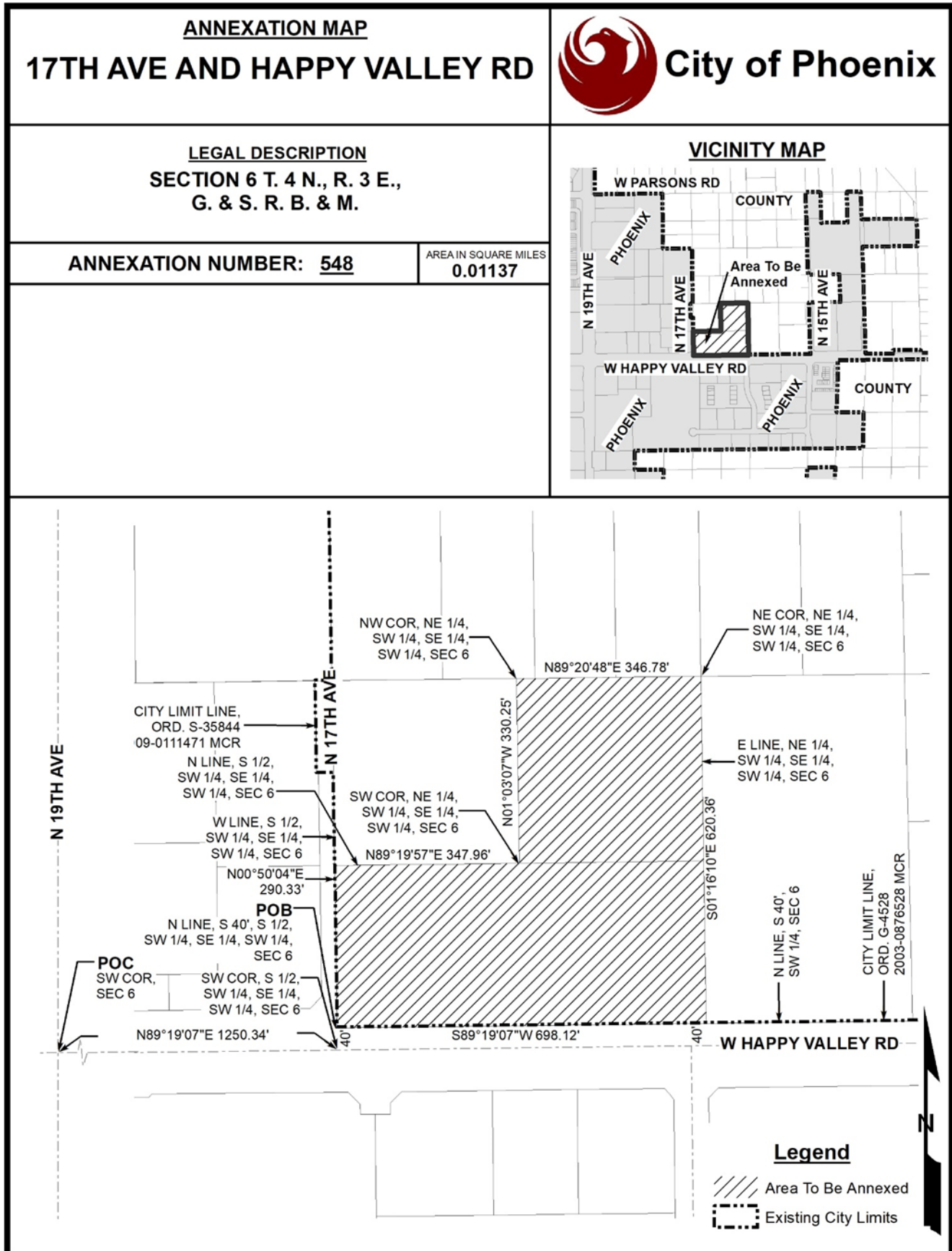

LEGAL DESCRIPTION

17TH AVENUE AND HAPPY VALLEY ROAD

The South half of the Southwest quarter of the Southwest quarter of the Southwest quarter AND the Northeast quarter of the Southwest quarter of the Southeast quarter of the Southwest quarter All of Section 6, Township 4 North, Range 3 East of the Gila and Salt River Base and Meridian, Maricopa County, Arizona, Except the South 40 feet, being more particularly described as follows;

COMMENCING at the Southwest corner (City of Phoenix brass cap in handhole) of said Section 6, from which the South quarter (Maricopa County Department of Transportation brass cap flush) of said Section 6 bears North 89 Degrees 19 Minutes 07 Seconds East a distance 2647.18 feet;

Thence North 89 Degrees 19 Minutes 07 Seconds East along the South line of said Southwest quarter of Section 6 a distance of 1250.34 feet to the Southwest corner of said South half;

Thence North 00 Degrees 50 Minutes 04 Seconds East along the West line of said South half a distance of 40.00 feet to the North line of the South 40.00 feet of said South half, said point being the **TRUE POINT OF BEGINNING**;

Thence North 00 Degrees 50 Minutes 04 Seconds East along the West line a distance of 290.33 feet to the Northwest corner of said South half;

Thence North 89 Degrees 19 Minutes 57 Seconds East along the North line of said South half a distance of 347.96 feet to the Southwest corner of said Northeast quarter of the Southwest quarter of the Southeast quarter of the Southwest quarter;

Thence North 01 Degrees 03 Minutes 07 Seconds West along the West line of said Northeast quarter a distance of 330.25 feet to the Northwest corner of said Northeast quarter;

Thence North 89 Degrees 20 Minutes 48 Seconds East along the North line of said Northeast quarter a distance of 346.78 feet to the Northeast corner of said Northeast quarter;

Thence South 01 Degrees 16 Minutes 10 Seconds East along the East line of said Northeast quarter and said South half a distance of 620.36 feet to said North line of the South 40.00 feet;

Thence South 89 Degrees 19 Minutes 07 Seconds West along last said South North line a distance of 698.12 feet to the **POINT OF BEGINNING**.