

**ATTACHMENT A**

**THIS IS A DRAFT COPY ONLY AND IS NOT AN OFFICIAL COPY OF THE FINAL,  
ADOPTED ORDINANCE**

**ORDINANCE G-**

**AN ORDINANCE AMENDING SECTION 601 OF THE CITY OF  
PHOENIX ZONING ORDINANCE BY ADOPTING OFFICIAL  
SUPPLEMENTARY ZONING MAP 1300.**

\_\_\_\_\_  
  
BE IT RESOLVED BY THE COUNCIL OF THE CITY OF PHOENIX as  
follows:

SECTION 1. That Section 601 of the City of Phoenix Zoning Ordinance is  
hereby amended by adopting Official Supplementary Zoning Map 1300, which  
accompanies and is annexed to this ordinance and declared a part hereof.

PASSED by the Council of the City of Phoenix this 7th day of January,  
2026.

\_\_\_\_\_  
MAYOR

ATTEST:

\_\_\_\_\_  
City Clerk

APPROVED AS TO FORM:  
Julie M. Kriegh, City Attorney

By: \_\_\_\_\_  
\_\_\_\_\_

REVIEWED BY:

\_\_\_\_\_  
Ed Zuercher, City Manager

DI:arm:LF25-2627:01-07-2026

DRAFT

# OFFICIAL SUPPLEMENTARY ZONING MAP NO. 1300

Sheet 1 of 1

ORDINANCE NO. \_\_\_\_\_ AMENDING SECTION 601 OF THE CITY OF PHOENIX ZONING ORDINANCE

Passed by the Council of the City of Phoenix, Arizona this 7th day of January 2026.

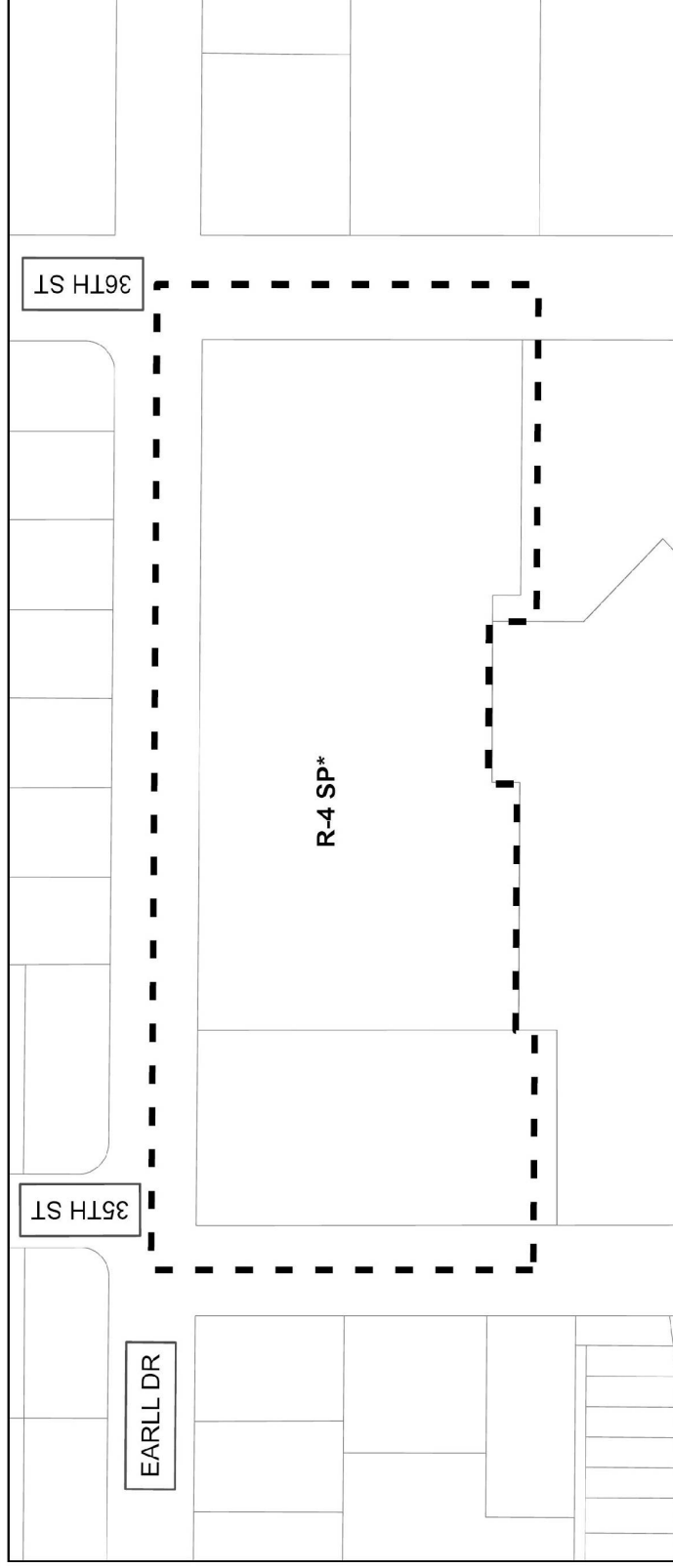

A Portion of Z-SP-3-66

Drawn by: KS \_\_\_\_\_



ZONING SUBJECT TO STIPULATIONS: \*  
AREA INVOLVED BOUNDED THUS: ■■■■■■