

ATTACHMENT A

**THIS IS A DRAFT COPY ONLY AND IS NOT AN OFFICIAL COPY OF THE FINAL,
ADOPTED ORDINANCE**

ORDINANCE G-

AN ORDINANCE AMENDING THE ZONING DISTRICT MAP ADOPTED PURSUANT TO SECTION 601 OF THE CITY OF PHOENIX ZONING ORDINANCE BY CHANGING THE ZONING DISTRICT CLASSIFICATION FOR THE PARCEL DESCRIBED HEREIN (CASE Z-121-25-4) FROM IND.PK. (INDUSTRIAL PARK) TO C-2 (INTERMEDIATE COMMERCIAL).

BE IT ORDAINED BY THE COUNCIL OF THE CITY OF PHOENIX, as follows:

SECTION 1. The zoning of a 1.34-acre site located approximately 765 feet south of the southwest corner of 37th Drive and Roanoke Avenue in a portion of Section 34, Township 2 North, Range 2 East, as described more specifically in Exhibit "A," is hereby changed from "IND.PK." (Industrial Park) to "C-2" (Intermediate Commercial).

SECTION 2. The Planning and Development Director is instructed to modify the Zoning Map of the City of Phoenix to reflect this use district classification change as shown in Exhibit "B."

SECTION 3. Due to the site's specific physical conditions and the use district applied for by the applicant, this rezoning is subject to the following stipulations,

violation of which shall be treated in the same manner as a violation of the City of

Phoenix Zoning Ordinance:

1. Upon complete redevelopment or development that increases the cumulative floor area of the building by more than 15% from that depicted on the site plan date stamped November 17, 2025, the following shall apply:
 - a. Where pedestrian walkways cross a vehicular path, the pathway shall be constructed of decorative pavers, stamped or colored concrete, or other pavement treatments, that visually contrasts parking and drive aisle surfaces, as approved by the Planning and Development Department.
 - b. A minimum of one of the required bicycle parking spaces shall include standard electrical receptacles for electric bicycle charging capabilities, as approved by the Planning and Development Department.
 - c. A minimum of 5% of the required vehicle parking spaces shall include EV Installed infrastructure.
 - d. A minimum of two green stormwater infrastructure (GSI) elements for stormwater management shall be implemented, as approved or modified by the Planning and Development and/or Street Transportation departments. This includes but is not limited to stormwater harvesting basins, bioswales, permeable pavement, etc., per the Greater Phoenix Metro Green Infrastructure and Low Impact Development Details for Alternative Stormwater Management.
 - e. A minimum 5-foot-wide sidewalk shall be constructed on the west side of 37th Drive, adjacent to the development.
2. The landscape setback along the west property line shall be planted with 2-inch caliper, large canopy evergreen trees, as approved by the Planning and Development Department.
3. A minimum of 2 bicycle parking spaces shall be provided and installed per the requirements of Section 1307.H of the Phoenix Zoning Ordinance.
4. A minimum of 25% of the employee and customer parking areas shall be shaded, as approved by the Planning and Development Department. Shade may be achieved by structures or by minimum 2-inch caliper, drought tolerant, shade trees, or a combination thereof.
5. Prior to final site plan approval, documentation shall be provided that demonstrates a commitment to participate in the City of Phoenix Water

Efficiency Program for a minimum of 10 years, or as approved by the Planning and Development Department.

6. All mitigation improvements shall be constructed and/or funded as identified in the accepted Traffic Impact Analysis dated June 4, 2025.
7. Replace unused driveways with sidewalk, curb, and gutter. Also, replace any broken or out-of-grade curb, gutter, sidewalk, and curb ramps on all streets and upgrade all off-site improvements to be in compliance with current ADA guidelines.
8. All streets within and adjacent to the development shall be constructed with paving, curb, gutter, sidewalk, curb ramps, streetlights, median islands, landscaping and other incidentals, as per plans approved by the Planning and Development Department. All improvements shall comply with all ADA accessibility standards.
9. In the event archaeological materials are encountered during construction, the developer shall immediately cease all ground-disturbing activities within a 33-foot radius of the discovery, notify the City Archaeologist, and allow time for the Archaeology Office to properly assess the materials.
10. Prior to final site plan approval, the landowner shall execute Proposition 207 waiver of claims form. The waiver shall be recorded with the Maricopa County Recorder's Office and delivered to the City to be included in the rezoning application file for record.

SECTION 4. If any section, subsection, sentence, clause, phrase or portion of this ordinance is for any reason held to be invalid or unconstitutional by the decision of any court of competent jurisdiction, such decision shall not affect the validity of the remaining portions hereof.

PASSED by the Council of the City of Phoenix this 4th day of February, 2026.

MAYOR

ATTEST:

Denise Archibald, City Clerk

APPROVED AS TO FORM:
Julie M. Kriegh, City Attorney

By:

REVIEWED BY:

Ed Zuercher, City Manager

Exhibits:
A – Legal Description (1 Page)
B – Ordinance Location Map (1 Page)

EXHIBIT A

LEGAL DESCRIPTION FOR Z-121-25-4

APN: 108-11-035

Lot 17, Thomas Road Properties, according to Book 214 of Maps, page 30, records of Maricopa County, Arizona

Gross Acreage: 1.35

Section: 34

Township: 2N

Range: 2E

DRAFT

ORDINANCE LOCATION MAP

EXHIBIT B

ZONING SUBJECT TO STIPULATIONS: *
SUBJECT AREA: ■ ■ ■ ■ ■

Zoning Case Number: Z-121-25-4
Zoning Overlay: N/A
Planning Village: Maryvale

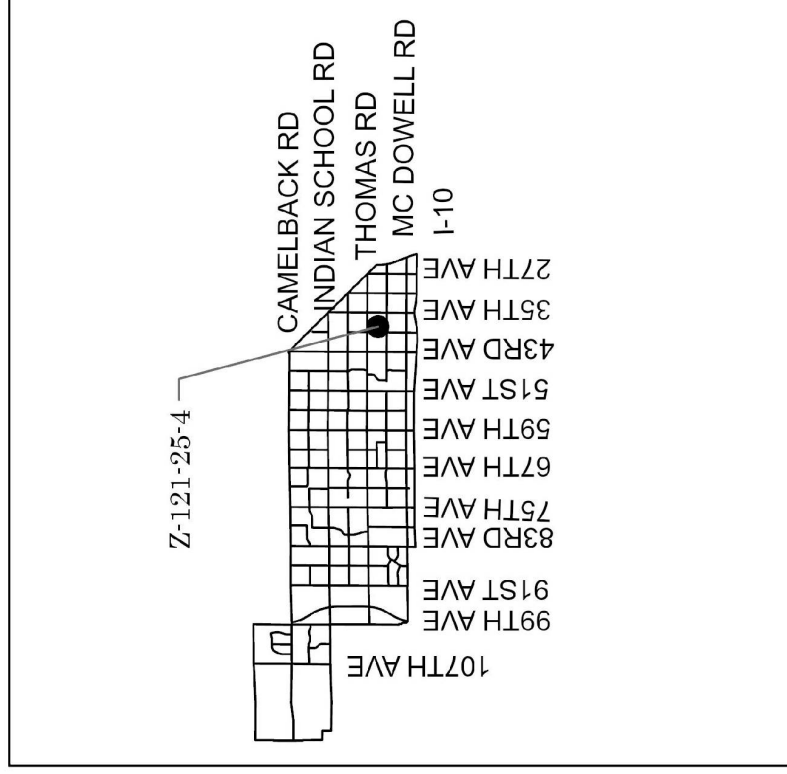
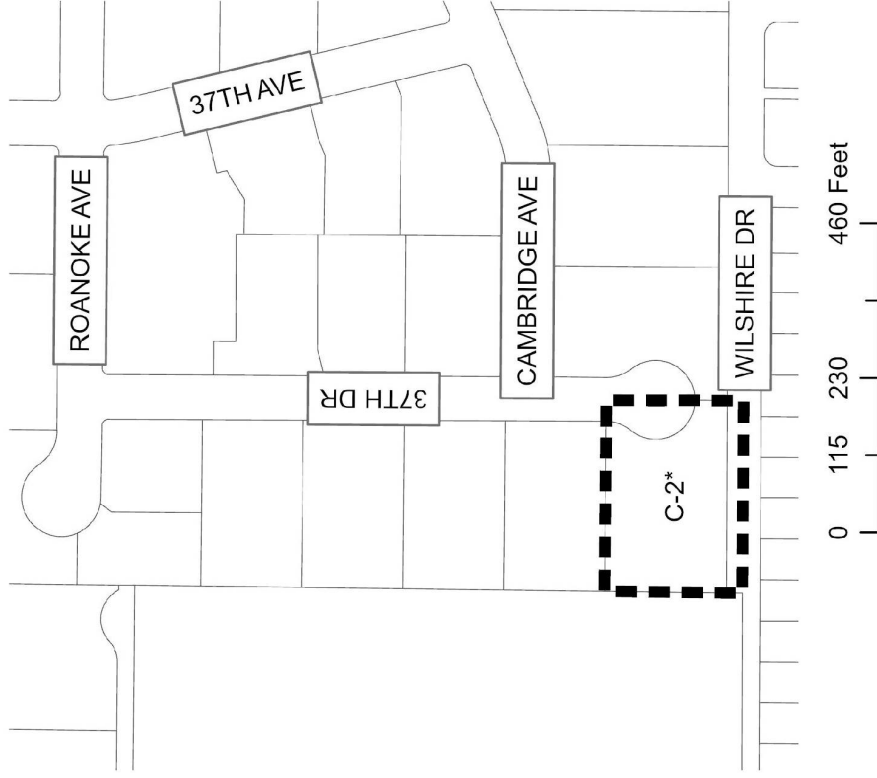

NOT TO SCALE



Drawn Date: 1/5/2026